

SURFACE MOUNT AUDIO JACKS

- Mates with 2.5mm and 3.5mm plugs
- Designed for reliable interface with audio equipment including computer speakers, headphones, sound cards, cell phones, etc.
- Models available for mono and stereo applications
- Low profile, surface mount design

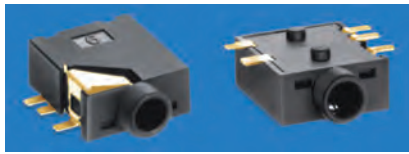

SPECIFICATIONS

Housing: Polyamide, UL Rated 94V-0
Ground Terminal: .012 (.30) thick Brass, Gold Flash ①
Spring Contacts: .008 (.20) thick Phosphor Bronze, Gold Flash ② ⑤
Shunt Terminals: .012 (.30) thick Brass, Gold flash ③ ④

FOR 2.5 mm PLUGS

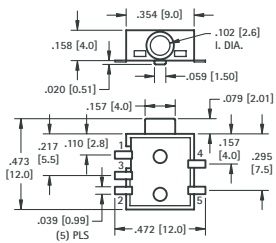

CAT. NO. 980TR (Stereo)

CAT. NO. 982TR (Mono)

Tape Spec's: 24mm wide; 16mm pitch
Reel Spec's: 15 inch reel (1,000 pieces per reel)

SUPPLIED ON TAPE AND REEL

Pad Layout

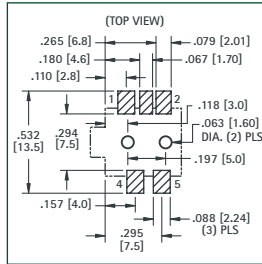

STEREO SCHEMATIC



FOR 3.5 mm PLUGS

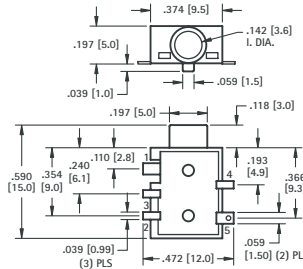

CAT. NO. 981TR (Stereo)

CAT. NO. 983TR (Mono)

Tape Spec's: 24mm wide; 16mm pitch
Reel Spec's: 15 inch reel (800 pieces per reel)

Pad Layout

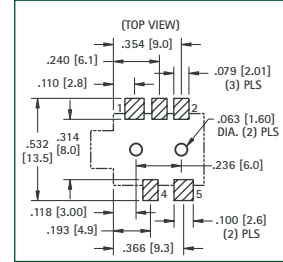

"F" FEMALE CONNECTOR

SNAP-FIT PC MOUNT

- Low profile
- Snap-fit mounting for positive retention during wave soldering
- Rugged, stable construction facilitates reliable mating
- High reliability, manufactured using Nickel Plated Brass bodies and Tin Plated Phosphor Bronze contacts
- Supplied with washer and nut

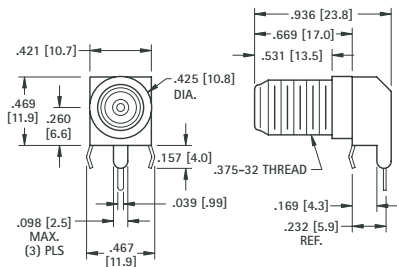

Mounting Detail

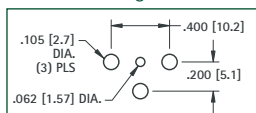

CAT. NO. 911

PANEL MOUNT PHONO JACKS

- Mates with .125 (3.12) dia. pin
- Color coded for ease of identification
- Mounts to panel in .296 (7.6) dia. hole
- Complete with nut and solder lug

ROUND BASE

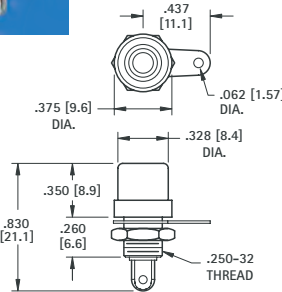

CAT. NO.	INSULATOR COLOR
580	RED
574	BLACK

HEX BASE

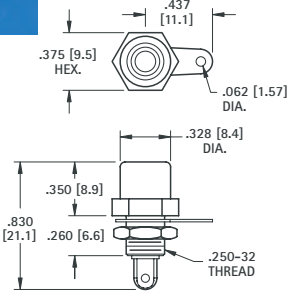

CAT. NO.	INSULATOR COLOR
581	WHITE
582	RED
576	BLACK
583	YELLOW

MATERIAL:
Brass, Nickel Plate

COLOR KEYED - PC PHONO JACKS

- Mates with .125 (3.2) diameter pins
- Features a normally closed circuit
- Various colors for circuit identification
- Snap-fit mounting for positive retention during wave soldering

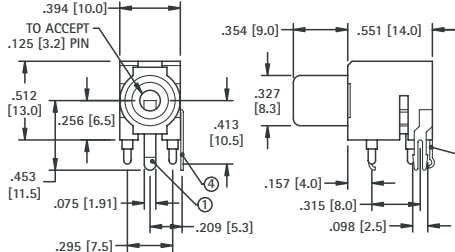
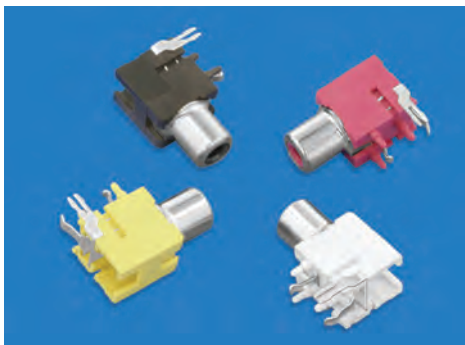

CAT. NO.	INSULATOR COLOR
970	WHITE
971	RED
972	BLACK
973	YELLOW

SPECIFICATIONS

Housing: PBT
Ground Terminal: .020 (.51) thick Brass, Nickel Plate ①
Spring Contact: .012 (.30) thick Phosphor Bronze, Silver Plate ③
Shunt Terminal: .016 (.41) thick Brass, Silver Plate ④

SCHEMATIC



Mounting Detail

